

**SONY®**

# User guide

Xperia™ Ear  
XEA10

# Contents

<b>Introduction.....</b>	<b>3</b>
General overview.....	3
Hardware overview.....	3
<b>Getting started.....</b>	<b>4</b>
Charging your Xperia™ Ear.....	4
Turning the Xperia™ Ear on or off.....	5
Pairing the Xperia™ Ear with an Android™ device.....	5
Wearing your Xperia™ Ear.....	6
LED indicators.....	7
Resetting the Xperia™ Ear.....	8
<b>Using your Xperia™ Ear.....</b>	<b>9</b>
Using voice control.....	9
Calling.....	9
Messaging.....	10
Searching for information.....	10
Getting tasks done.....	11
Getting up-to-date information.....	11
Listening to music.....	11
Launching applications.....	11
Using head gestures.....	12
Changing interaction preferences.....	12
Changing the voice interaction language.....	12
Changing the key behaviour.....	12
Checking dialogue history.....	13
Managing notifications.....	13
<b>Legal information.....</b>	<b>14</b>
Declaration of Conformity for XEA10.....	15

# Introduction

## General overview

The Xperia™ Ear lets you carry on communicating while you work and play. It reads out messages, notifications, weather, news and more. So whatever you're doing, you don't need to miss a thing.

- Use voice commands for hands-free use. Tell your Xperia™ Ear what you need from your paired Android™ device and it will deliver. Commands include making a call, playing a music track or dictating a quick message. Your Xperia™ Ear uses the **Assistant** application by default to carry out voice commands.
- Set up your Xperia™ Ear using the **Xperia™ Ear** application. Set it to deliver information for the day ahead, choose what happens when you tap it, and select notifications for applications.

💡 The **Assistant** only supports a limited number of languages. For more information about the **Assistant** and examples of how to use it, see <http://s-assistant.sony.net/>.

## Hardware overview

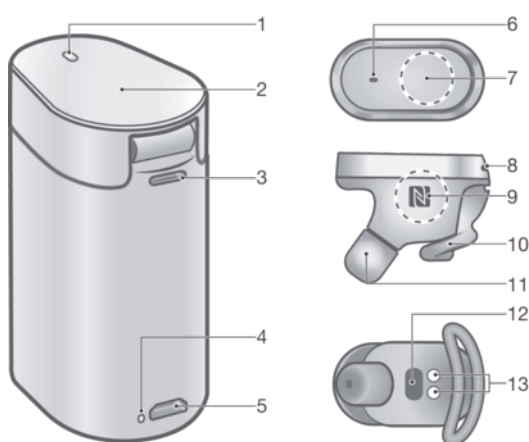

1	Window to Xperia™ Ear battery level LED
2	Lid
3	Strap hole
4	Charging case battery level LED
5	Micro-USB port
6	LED indicator and primary microphone
7	<b>Assistant/Call key</b>
8	Secondary microphone
9	NFC detection area
10	Arc supporter
11	Earbud
12	Proximity sensor
13	Charging case connector

# Getting started

## Charging your Xperia™ Ear

Your Xperia™ Ear comes with a portable charging case, which itself can be charged from a power outlet or from a computer. Before using your Xperia™ Ear for the first time, you need to charge it for at least 30 minutes. You can charge the Xperia™ Ear and the charging case simultaneously.

- ! Your Xperia™ Ear turns off automatically when placed inside its charging case.

### To charge your charging case



- 1 Plug one end of the cable into the Micro-USB port of your Xperia™ Ear charging case.
- 2 Plug the other end of the USB cable into the charger or into the USB port of a computer. While the charging case's battery is charging, the LED indicator at the base of the case changes from red to orange. The LED indicator changes to green when you reach 80% battery power.

- ! Sony USB cables are recommended.

### To charge your Xperia™ Ear

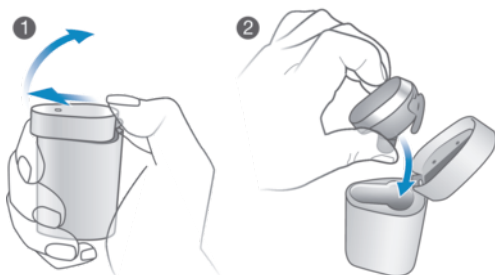

- 1 Open the charging case by pushing its lid forward with your thumb.
- 2 Put your Xperia™ Ear into the charging case and close the lid. While the Xperia™ Ear's battery is charging, the LED indicator on the lid changes from red to orange. The LED indicator changes to green when you reach 80% battery power.

- 💡 When you put your Xperia™ Ear into the charging case, the LED at the base of the case blinks three times in a colour based on the battery level. A fully charged case can be used to charge your Xperia™ Ear up to three times without connecting it to a power outlet or a computer.

- 💡 Enable the **Battery Care** function to maximise the battery lifespan. You can find **Battery Care** in the **Settings** menu of the **Xperia™ Ear** application.

### To check the battery level of your Xperia™ Ear

- 1 From your application screen, find and tap **Xperia™ Ear**.
- 2 The battery level is displayed.

While your Xperia™ Ear is in the charging case, the LED indicator on the lid displays its estimated battery level. Another LED located beside the charger's Micro-USB port displays the battery level of the charging case while it is connected to a power outlet.

Red	The battery level is less than 15% and charging.
Orange	The battery level is between 15% and 80% and charging.
Green	The battery level is above 80% and charging.

## Turning the Xperia™ Ear on or off

### To turn on the Xperia™ Ear

- The Xperia™ Ear automatically turns on when you remove it from the charging case.

### To turn off the Xperia™ Ear

- Place your Xperia™ Ear inside the charging case.
- ! If the Xperia™ Ear is not connected to an Android™ device for 15 minutes or longer, it will automatically shut down.

## Pairing the Xperia™ Ear with an Android™ device

For your Xperia™ Ear to work properly, you must install the latest version of the **Xperia™ Ear** application on your Android™ device, and then pair it with your Xperia™ Ear.

- 💡 The **Xperia™ Ear** application is available on Google Play™. We recommend using a Wi-Fi connection to avoid data traffic costs.
- ! When using the Xperia™ Ear with a Wi-Fi only Android™ tablet, the host application may not be available for download, and functions such as calling, text messaging, mobile data traffic and the **Assistant** will not work.

### To set up your Xperia™ Ear using NFC

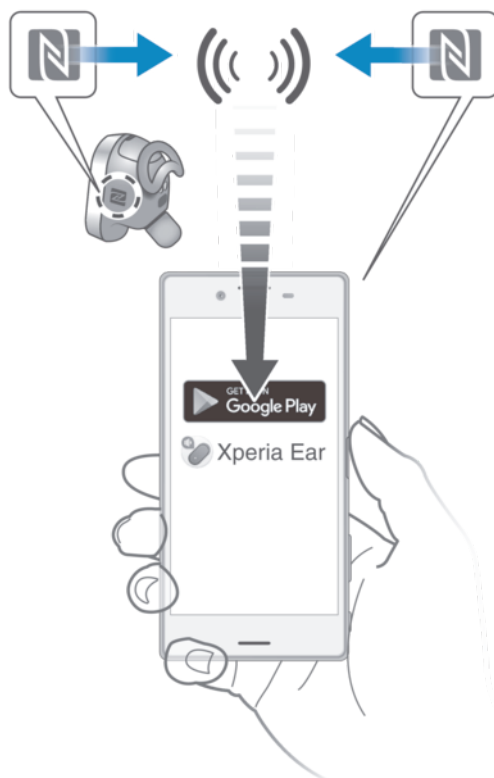

- 1 Make sure that your Xperia™ Ear is charged.
  - 2 Make sure that NFC is turned on and that the screen is active and unlocked.
  - 3 Touch the NFC area of your Xperia™ Ear against the NFC detection area of the Android™ device, then follow the on-screen instructions to install the **Xperia™ Ear** application and pair your Xperia™ Ear with an Android™ device.
- 💡 You can connect and use your Xperia™ Ear with two devices at the same time - for example a phone and a tablet, or a work phone and a private phone. To connect and use your Xperia™ Ear with two devices, follow the steps outlined above on the second device. When you have two Android™ devices connected to your Xperia™ Ear, the **Assistant** is only available on one of the devices.
- ! If you have problems pairing your Xperia™ Ear with an Android™ device using NFC, you can pair them manually using Bluetooth®.

#### To set up your Xperia™ Ear using Bluetooth®

- 1 Make sure that your Xperia™ Ear is charged.
- 2 Make sure that you have installed or updated the **Xperia™ Ear** application to the latest version on your device.
- 3 Turn on Bluetooth®, then scan for Bluetooth® devices and select XEA10 from the list of available devices.
- 4 Follow the on-screen instructions.

#### Reconnecting the Xperia™ Ear

If Bluetooth® is turned on, your Xperia™ Ear automatically performs a series of reconnection attempts. If this automatic reconnection is unsuccessful, you can use the **Assistant/Call key** to try again manually, or you can pair again using NFC or Bluetooth®.

#### Wearing your Xperia™ Ear



You can wear the Xperia™ Ear in whichever ear you prefer. The arc supporter and the earbud are designed to ensure a comfortable and secure fit. They are replaceable and available in different sizes.

- ! Using your Xperia™ Ear may in some cases distract you and cause danger, for example if you are operating machinery or driving a vehicle. The use of headsets in such circumstances may be restricted or prohibited in some countries.

#### Arc supporter



The arc supporter helps you to fit the Xperia™ Ear comfortably and securely in your ear. If you prefer not to use it, use the arc supporter cap.

### To change the arc supporter

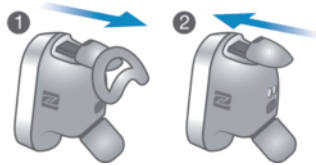
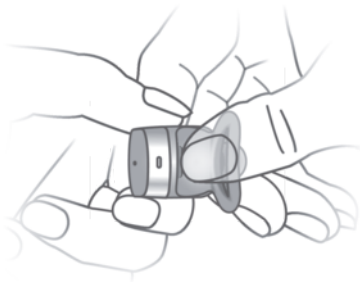

- 1 To remove the arc supporter, place your fingernail in the small gap at the edge of the arc supporter, then gently pull it outwards.
  - 2 To attach the arc supporter, position it as shown in the illustration, then gently slide it forward until it fits into place.
- ! Do not try to forcefully remove the arc supporter from the Xperia™ Ear. In order to avoid permanent damage, make sure you follow the correct procedure.

### Earbud

A range of earbud options are supplied with your Xperia™ Ear for maximum comfort.

#### Open type



The open type earbud is available in one size, designed to fit all ears.

#### Canal type



The canal type earbud maximises the listening experience by blocking out ambient noise, providing a clearer sound quality. It is available in three different sizes: small, medium and large.

### Caring for your Xperia™ Ear and your skin

To help avoid skin irritation, clean your Xperia™ Ear regularly. Remove and rub the earbud with a dry cloth.

- ⚠ If you start to experience skin irritation or an allergic reaction, stop wearing your Xperia™ Ear. Contact your physician if symptoms persist.

### LED indicators

There are three LED indicators to let you know of the status of the Xperia™ Ear and the charging case. One on the Xperia™ Ear, one on the lid of the charging case and one next to the charging case's Micro-USB port.

### Xperia™ Ear LED:

Flashing in blue	In standby mode and not connected
Flashing in red	Low battery
Flashing in white	Incoming call/the <b>Assistant</b> is active

The LED on the charging case's lid shows the battery level of the Xperia™ Ear:

Red	The battery level is less than 15% and charging
Orange	The battery level is between 15% and 80% and charging
Green	The battery level is above 80% and charging

The LED next to the charging case's Micro-USB port shows the battery level of the case when it is connected to a power outlet:

Red	The battery level is less than 15% and charging
Orange	The battery level is between 15% and 80% and charging
Green	The battery level is above 80% and charging
No light	Charging complete

- ! The LED indicator next to the charging case's Micro-USB port only indicates the case's battery level.

## Resetting the Xperia™ Ear

Restart your Xperia™ Ear if it behaves unexpectedly. If restarting does not solve the issue, you can perform a factory data reset.

### To restart your Xperia™ Ear

- Press and hold down the **Assistant/Call key** for 10 seconds.

### To perform a factory data reset

- Quickly press the **Assistant/Call key** twice, then press and hold it down for 5 seconds. If the factory data reset is successful, the LED indicator starts flashing in green.
- ! All information about paired devices is deleted when you reset your Xperia™ Ear. After a factory data reset, the Xperia™ Ear will be turned off.



# Using your Xperia™ Ear

## Using voice control

You can use the voice control feature of the Xperia™ Ear to control your Android™ device hands-free. Your Xperia™ Ear uses the **Assistant** application by default to carry out voice commands. The **Assistant** responds to your various requests and carries out specific daily tasks.

- ! The **Assistant** only supports a limited number of languages. For more information about the **Assistant** and examples of how to use it, see <http://s-assistant.sony.net/>.

### To activate voice control

- 1 Press the **Assistant/Call key** on your Xperia™ Ear briefly to activate voice control.
  - 2 After the tone, ask the **Assistant** a question or give it a command in one of the supported languages. If the **Assistant** doesn't recognise your question or command, try rephrasing the sentence. For more information about the **Assistant** and examples of how to use it, see <http://s-assistant.sony.net/>.
- 💡 You can select your preferred voice control application in the Xperia™ Ear application settings.

### To adjust the volume

Press the volume key up or down on your Android™ device.

## Calling

### To make a phone call

- 1 Press the **Assistant/Call key** on your Xperia™ Ear briefly to activate voice control.
- 2 After the tone, say "Call" in one of the supported languages and then say the contact name you want to call. For example, say "Call Peter".
- 3 The **Assistant** repeats the name of the recipient and asks for confirmation.
- 4 Say "Yes" or "No" or use head gestures to confirm or decline.
- 5 If the **Assistant** fails to understand you, return to step 1.
- 6 To cancel an outgoing call, press the **Assistant/Call key** again briefly.

### To answer or end an incoming call

- 1 Briefly press the **Assistant/Call key** on your Xperia™ Ear.
- 2 Press the **Assistant/Call key** again to hang up.

### To reject an incoming call

- Press and hold the **Assistant/Call key** on your Xperia™ Ear.

### To mute or unmute the microphone during a call

- Press and hold down the **Assistant/Call key**.

### To return a missed call

- 1 Press the **Assistant/Call key** on your Xperia™ Ear briefly to activate voice control.
- 2 After the tone, ask “Did I miss any calls?” in one of the supported languages.
- 3 The **Assistant** reads out who you have missed calls from.
- 4 After the tone, say “Call back” and then say the contact name you want to call back. For example, say “Call back Peter”.

! You can only return missed calls that you received in the last 24 hours.

#### To answer a second call and put the ongoing call on hold

- Briefly press the **Assistant/Call key**.

#### To switch between multiple calls

- Press the **Assistant/Call key** twice.

## Messaging

#### To create and send a text message

- 1 Press the **Assistant/Call key** on your Xperia™ Ear briefly to activate voice control.
- 2 After the tone, say “Send a message to” in one of the supported languages and then say the contact name you want to text. For example, say “Send a message to Peter”.
- 3 When prompted, dictate the message you want to send.
- 4 The **Assistant** repeats your message and asks for confirmation.
- 5 Say “Yes” or “No” or use head gestures to confirm or decline.
- 6 If the **Assistant** fails to understand you, return to step 1.

#### To reply to a text message

- 1 From your application screen, find and tap **Xperia™ Ear > Settings > Assistant settings > Reply to message**.
- 2 When you receive a new message, the **Assistant** reads it back to you and asks whether you would like to reply.
- 3 Say “Yes” in one of the supported languages or nod your head to reply.
- 4 When prompted, dictate the message you want to send.
- 5 The **Assistant** repeats your message and asks for confirmation.
- 6 Say “Yes” or “No” or use head gestures to confirm or decline.

💡 This function can also be used by supported instant messaging services. For more information about the **Assistant** and supported instant messaging services, see <http://s-assistant.sony.net/>.

## Searching for information

You can ask the **Assistant** to give you a generic description about anything, using information available online.

#### To search for information using voice control

- 1 Press the **Assistant/Call key** on your Xperia™ Ear to activate voice control.
- 2 After the tone, ask the **Assistant** to look up a word in one of the supported languages, for example, “Search for Jupiter on Wikipedia” or “Wikipedia search for sushi”.
- 3 If the **Assistant** fails to understand your question or command, return to step 1.

## Getting tasks done

You can ask the **Assistant** to carry out specific daily tasks, such as creating a new event in your calendar, getting directions, setting the alarm or timer, or starting the stopwatch.

### To get tasks done using voice control

- 1 Press the **Assistant/Call key** on your Xperia™ Ear to activate voice control.
- 2 After the tone, give the **Assistant** a command in one of the supported languages, for example, "Set the timer for three minutes" or "Ring my cell".
- 3 If the **Assistant** fails to understand your question or command, return to step 1.

## Getting up-to-date information

You can ask the **Assistant** to answer generic questions that help you to schedule your day ahead, for example, questions about upcoming calendar events, date and time, the news or the weather forecast.

### To get up-to-date information using voice control

- 1 Press the **Assistant/Call key** on your Xperia™ Ear to activate voice control.
- 2 After the tone, ask the **Assistant** a question in one of the supported languages, for example, "What's my next event?" or "What's the weather like in Tokyo?".
- 3 If the **Assistant** fails to understand your question or command, return to step 1.

## Listening to music

You can ask the **Assistant** to start playing music.

### To start playing music using voice control

- 1 Press the **Assistant/Call key** on your Xperia™ Ear to activate voice control.
  - 2 After the tone, say "Play [Song title]" in one of the supported languages to listen to a specific song. To start playing a randomly selected song, say "Play music".
  - 3 If the **Assistant** fails to understand your question or command, return to step 1.
- ! You can only use Sony's **Music** application or the Google Play Music application.

## Launching applications

You can ask the **Assistant** to launch applications.

### To assign Magic Words to your applications

- 1 From your application screen, find and tap **Xperia™ Ear > Settings > Magic Words**.
- 2 Select an application you want to set up **Magic Words** for and follow the on-screen instructions.

### To launch applications using voice control

- 1 Press the **Assistant/Call key** on your Xperia™ Ear to activate voice control.
- 2 After the tone, say "Launch" in one of the supported languages and then say the magic word previously set for the application you want to launch, for example, "Launch [Magic Word]."
- 3 If the **Assistant** fails to understand your question or command, return to step 1.

## Using head gestures

You can use head gestures to provide feedback to your Xperia™ Ear.

For example, if your Xperia™ Ear notifies you of an incoming message, and asks whether you would like to reply, just nod or shake your head to give positive or negative feedback.

### To enable or disable head gestures

- 1 From your application screen, find and tap **Xperia™ Ear > Settings > Head gesture**.
- 2 Tap the slider to enable or disable this function.

### To use head gestures

- Nod your head to provide positive feedback.
- Shake your head to provide negative feedback.

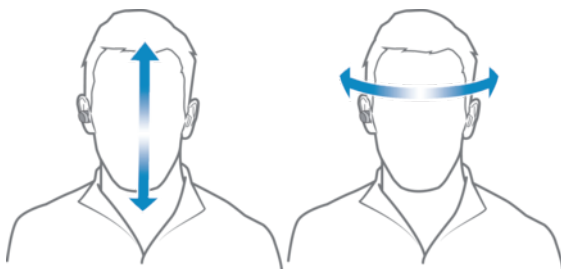

## Changing interaction preferences

You can choose the style of interaction you prefer when interacting with the **Assistant**. In **Normal** mode, you will be asked to confirm most actions before they are carried out. In **Simple** mode, some of the confirmation dialogues will be skipped.

### To change the interaction preference

- 1 From your application screen, find and tap **Xperia™ Ear > Settings > Assistant settings > Interaction preference**.
- 2 Select an option.

## Changing the voice interaction language

You can interact with the **Assistant** using one of the supported languages.

### To change the voice interaction language

- 1 From your application screen, find and tap **Xperia™ Ear > Settings > Assistant settings > Voice interaction language**.
- 2 Select an option.

## Changing the key behaviour

You can trigger different functions by short or long pressing the **Assistant/Call key** on your Xperia™ Ear.

### To change the key behaviour

- 1 From your application screen, find and tap **Xperia™ Ear > Settings**.
- 2 Tap **Short-press** or **Long press** and then tap the slider to enable this function.
- 3 Select an option.

## Checking dialogue history

You can check the dialogue history to see recent interactions with the **Assistant**.

### To check dialogue history

- 1 From your application screen, find and tap **Xperia™ Ear** >



- 2 Select an item.

## Managing notifications

Receive personalised information for updates on the go. Place your Xperia™ Ear in your ear to receive updates about notifications, your schedule, weather, news and more.

### To enable or disable start-up messages

- 1 From your application screen, find and tap **Xperia™ Ear** > **Start-up messages**.
  - 2 Select the items you want to include in the start-up notification when you place your Xperia™ Ear in your ear.
- ! The Xperia™ Ear may not read out all messages and notifications, depending on when they were received.

### To enable or disable voice notifications

- 1 From your application screen, find and tap **Xperia™ Ear** > **Voice notifications**.
- 2 Select the applications and services you want to receive notifications for.

# Legal information

## Sony XEA10



Prior to use, please read the *Important information* leaflet separately provided.

This User guide is published by Sony Mobile Communications Inc. or its local affiliated company, without any warranty. Improvements and changes to this User guide necessitated by typographical errors, inaccuracies of current information, or improvements to programs and/or equipment, may be made by Sony Mobile Communications Inc. at any time and without notice. Such changes will, however, be incorporated into new editions of this User guide.

All rights reserved.

©2016 Sony Mobile Communications Inc.

Interoperability and compatibility among Bluetooth® devices varies. Device generally supports products utilizing Bluetooth® spec. 1.2 or higher, and Headset or Handsfree profile.

Sony is the trademark or registered trademark of Sony Corporation. Bluetooth® is the trademark of the Bluetooth (SIG) Inc. and is used under license. All other marks are the property of their respective owners. All rights reserved.

All product and company names mentioned herein are the trademarks or registered trademarks of their respective owners. Any rights not expressly granted herein are reserved. All other trademarks are property of their respective owners.

Visit [www.sonymobile.com](http://www.sonymobile.com) for more information.

All illustrations are for illustration only and may not accurately depict the actual accessory.

## Declaration of Conformity for XEA10



Hereby, Sony Mobile declares that the equipment type **RD-0221** is in compliance with Directive; **2014/53/EU**. The full text of the EU declaration of conformity is available at the following internet address: <http://www.compliance.sony.de/>

С настоящото Sony Mobile декларира, че радиосъоръжение тип **RD-0221** е в съответствие с Директива; **2014/53/ЕС**. Цялостният текст на ЕС декларацията за съответствие може да се намери на следния интернет адрес: <http://www.compliance.sony.de/>

Sony Mobile ovime izjavljuje da je radijska oprema tipa **RD-0221** u skladu s Direktivom; **2014/53/EU**. Cjeloviti tekst EU izjave o sukladnosti dostupan je na sljedećoj internetskoj adresi: <http://www.compliance.sony.de/>

Sony Mobile tímto prohlašuje, že radiové zařízení typ **RD-0221** je v souladu se směrnicí; **2014/53/EU**. Úplné znění EU prohlášení o shodě je k dispozici na této internetové adrese: <http://www.compliance.sony.de/>

Hermed erklarer Sony Mobile, at radioudstyrstypen **RD-0221** er i overensstemmelse med direktiv; **2014/53/EU**. EU-overensstemmelseserklaringens fulde tekst kan findes på følgende internetadresse: <http://www.compliance.sony.de/>

Hierbij verklaart Sony Mobile dat het type radioapparatuur **RD-0221** conform is met Richtlijn; **2014/53/EU**. De volledige tekst van de EU-conformiteitsverklaring kan worden geraadpleegd op het volgende internetadres: <http://www.compliance.sony.de/>

Käesolevaga deklareerib Sony Mobile, et käesolev raadioseadme tüüp **RD-0221** vastab direktiivi; **2014/53/EL** nõuetele. ELi vastavusdeklaratsiooni täielik tekst on kättesaadav järgmisel internetiaadressil: <http://www.compliance.sony.de/>

Sony Mobile vakuuttaa, että radiolaitetyypin **RD-0221** on direktiivin; **2014/53/EU** mukainen. EU-vaatimustenmukaisuusvakuutuksen täysimittainen teksti on saatavilla seuraavassa internetosoitteessa: <http://www.compliance.sony.de/>

Le soussigné, Sony Mobile, déclare que l'équipement radioélectrique du type **RD-0221** est conforme à la directive; **2014/53/UE**. Le texte complet de la déclaration UE de conformité est disponible à l'adresse internet suivante: <http://www.compliance.sony.de/>

Hiermit erklärt Sony Mobile, dass der Funkanlagentyp **RD-0221** der Richtlinie; **2014/53/EU** entspricht. Der vollständige Text der EU-Konformitätserklärung ist unter der folgenden Internetadresse verfügbar: <http://www.compliance.sony.de/>

Με την παρούσα η Sony Mobile, δηλώνει ότι ο ραδιοεξοπλισμός **RD-0221** πληροί τους όρους της οδηγίας; **2014/53/ΕΕ**. Το πλήρες κείμενο της δήλωσης συμμόρφωσης ΕΕ διατίθεται στην ακόλουθη ιστοσελίδα στο διαδίκτυο: <http://www.compliance.sony.de/>

Sony Mobile igazolja, hogy a **RD-0221** típusú rádióberendezés megfelel a; **2014/53/EU** irányelvnek. Az EU-megfelelőségi nyilatkozat teljes szövege elérhető a következő internetes címen: <http://www.compliance.sony.de/>

Il fabbricante, Sony Mobile, dichiara che il tipo di apparecchiatura radio **RD-0221** è conforme alla direttiva; **2014/53/EU**. Il testo completo della dichiarazione di conformità UE è disponibile al seguente indirizzo Internet: <http://www.compliance.sony.de/>

Ar šo Sony Mobile deklarē, ka radioiekārta **RD-0221** atbilst Direktīvai; **2014/53/ES**. Pilns ES atbilstības deklarācijas teksts ir pieejams šādā interneta vietnē: <http://www.compliance.sony.de/>

Mes, Sony Mobile, patvirtiname, kad radijo įrenginių tipas **RD-0221** atitinka Direktyvą; **2014/53/ES**. Visas ES atitikties deklaracijos teksto prieinamas šiuo interneto adresu: <http://www.compliance.sony.de/>

Il-Kumpanija Sony Mobile tiddikjara li t-tagħmir tar-radju tat tip **RD-0221** huwa konformi mad-Direttiva; **2014/53/EU**. It-test shiħ tad-dikjarazzjoni ta' konformita tal-UE huwa disponibbli f'dan l-indirizz tal-Internet li ġej: <http://www.compliance.sony.de/>

Herved erklarer Sony Mobile at radioutstyr typen **RD-0221** er i samsvar med direktiv; **2014/53/EU**. EU-erklaring fulltekst finner du på Internett under: <http://www.compliance.sony.de/>

Sony Mobile niniejszym oświadcza, że typ urządzenia radiowego **RD-0221** jest zgodny z dyrektywą; **2014/53/UE**. Pełny tekst deklaracji zgodności UE jest dostępny pod następującym adresem internetowym: <http://www.compliance.sony.de/>

O(a) abaixo assinado(a) Sony Mobile declara que o presente tipo de equipamento de rádio **RD-0221** está em conformidade com a Diretiva; **2014/53/UE**. O texto integral da declaração de conformidade está disponível no seguinte endereço de Internet: <http://www.compliance.sony.de/>

Prin prezenta, Sony Mobile declară că tipul de echipament radio **RD-0221** este în conformitate cu Directiva; **2014/53/UE**. Textul integral al declarației UE de conformitate este disponibil la următoarea adresă internet: <http://www.compliance.sony.de/>

Sony Mobile potrjuje, da je tip radijske opreme **RD-0221** skladen z Direktivo; **2014/53/EU**. Celotno besedilo izjave EU o skladnosti je na voljo na naslednjem spletnem naslovu: <http://www.compliance.sony.de/>

Sony Mobile týmto vyhlasuje, že rádiové zariadenie typu **RD-0221** je v súlade so smernicou; **2014/53/EÚ**. Úplné EÚ vyhlásenie o zhode je k dispozícii na tejto internetovej adrese: <http://www.compliance.sony.de/>

Por la presente, Sony Mobile declara que el tipo de equipo radioeléctrico **RD-0221** es conforme con la Directiva; **2014/53/UE**. El texto completo de la declaración UE de conformidad está disponible en la dirección Internet siguiente: <http://www.compliance.sony.de/>

Härmed försäkrar Sony Mobile att denna typ av radioutrustning **RD-0221** överensstämmer med direktiv; **2014/53/EU**. Den fullständiga texten till EU-försäkran om överensstämmelse finns på följande webbadress: <http://www.compliance.sony.de/>

Manufacturer: Sony Mobile Communications Inc, 4-12-3 Higashi- Shinagawa, Shinagawa-ku, Tokyo, 140-0002 Japan

For EU product compliance: Sony Belgium, bijkantoor van Sony Europe Limited, Da Vincilaan 7-D1, 1935 Zaventem, Belgium

Hersteller: Sony Mobile Communications Inc, 4-12-3 Higashi- Shinagawa, Shinagawa-ku, Tokyo, 140-0002 Japan

Für EU Produktkonformität: Sony Belgium, bijkantoor van Sony Europe Limited, Da Vincilaan 7-D1, 1935 Zaventem, Belgien

Producător: Sony Mobile Communications Inc, 4-12-3 Higashi- Shinagawa, Shinagawa-ku, Tokyo, 140-0002 Japan

Voor EU-product conformiteit: Sony Belgium, bijkantoor van Sony Europe Limited, Da Vincilaan 7-D1, 1935 Zaventem, België

Производитель: Sony Mobile Communications Inc, 4-12-3 Higashi- Shinagawa, Shinagawa-ku, Tokyo, 140-0002 Japan

За съответствие на продукти от ЕС: Sony Belgium, bijkantoor van Sony Europe Limited, Da Vincilaan 7-D1, 1935 Zaventem, Белгия

Proizvođač: Sony Mobile Communications Inc, 4-12-3 Higashi- Shinagawa, Shinagawa-ku, Tokyo, 140-0002 Japan

Za skladnost proizvoda u EU: Sony Belgium, bijkantoor van Sony Europe Limited, Da Vincilaan 7-D1, 1935 Zaventem, Belgija

Výrobce: Sony Mobile Communications Inc, 4-12-3 Higashi-Shinagawa, Shinagawa-ku, Tokyo, 140-0002 Japan



Pro technické požadavky dle směrnice EU: Sony Belgium, bijkantoor van Sony Europe Limited, Da Vincilaan 7-D1, 1935 Zaventem, Belgie

Κατασκευαστής: Sony Mobile Communications Inc, 4-12-3 Higashi- Shinagawa, Shinagawa-ku, Tokyo, 140-0002 Japan

Συμμόρφωση Προϊόντος με νομοθεσία Ε.Ε.: Sony Belgium, bijkantoor van Sony Europe Limited, Da Vincilaan 7-D1, 1935 Zaventem, Βέλγιο

Producent: Sony Mobile Communications Inc, 4-12-3 Higashi- Shinagawa, Shinagawa-ku, Tokyo, 140-0002 Japan

Overensstemmelse med EU lovgivning: Sony Belgium, bijkantoor van Sony Europe Limited, Da Vincilaan 7-D1, 1935 Zaventem, Belgien

Tootja: Sony Mobile Communications Inc, 4-12-3 Higashi-Shinagawa, Shinagawa-ku, Tokyo, 140-0002 Japan

EL toote vastavus: Sony Belgium, bijkantoor van Sony Europe Limited, Da Vincilaan 7-D1, 1935 Zaventem, Belgia

Valmistaja: Sony Mobile Communications Inc, 4-12-3 Higashi- Shinagawa, Shinagawa-ku, Tokyo, 140-0002 Japan

EU vaatimusten mukaisuus: Sony Belgium, bijkantoor van Sony Europe Limited, Da Vincilaan 7-D1, 1935 Zaventem, Belgia

Κατασκευαστής: Sony Mobile Communications Inc, 4-12-3 Higashi- Shinagawa, Shinagawa-ku, Tokyo, 140-0002 Japan

Συμμόρφωση Προϊόντος με νομοθεσία Ε.Ε.: Sony Belgium, bijkantoor van Sony Europe Limited, Da Vincilaan 7-D1, 1935 Zaventem, Βέλγιο

Gyártó: Sony Mobile Communications Inc, 4-12-3 Higashi-Shinagawa, Shinagawa-ku, Tokyo, 140-0002 Japan

Európai uniós termékbiztonság: Sony Belgium, bijkantoor van Sony Europe Limited, Da Vincilaan 7-D1, 1935 Zaventem, Belgium

Produttore: Sony Mobile Communications Inc, 4-12-3 Higashi- Shinagawa, Shinagawa-ku, Tokyo, 140-0002 Japan

Per la conformità del prodotto in ambito UE: Sony Belgium, bijkantoor van Sony Europe Limited, Da Vincilaan 7-D1, 1935 Zaventem, Belgio

Ražotājs: Sony Mobile Communications Inc, 4-12-3 Higashi- Shinagawa, Shinagawa-ku, Tokyo, 140-0002 Japan

Par ES produktu atbilstību: Sony Belgium, bijkantoor van Sony Europe Limited, Da Vincilaan 7-D1, 1935 Zaventem, Beļģija

Gamintojas: Sony Mobile Communications Inc, 4-12-3 Higashi- Shinagawa, Shinagawa-ku, Tokyo, 140-0002 Japan

Dēl ES gaminių atitikties: Sony Belgium, bijkantoor van Sony Europe Limited, Da Vincilaan 7-D1, 1935 Zaventem, Belgija

Produsent: Sony Mobile Communications Inc, 4-12-3 Higashi- Shinagawa, Shinagawa-ku, Tokyo, 140-0002 Japan

EU produkt samsvar: Sony Belgium, bijkantoor van Sony Europe Limited, Da Vincilaan 7-D1, 1935 Zaventem, Belgia

Producent: Sony Mobile Communications Inc, 4-12-3 Higashi- Shinagawa, Shinagawa-ku, Tokyo, 140-0002 Japan

Informacje o zgodności produktu z wymaganiami UE: Sony Belgium, bijkantoor van Sony Europe Limited, Da Vincilaan 7-D1, 1935 Zaventem, Belgia

Producător: Sony Mobile Communications Inc, 4-12-3 Higashi- Shinagawa, Shinagawa-ku, Tokyo, 140-0002 Japan

Pentru conformitatea UE a aparatului: Sony Belgium, bijkantoor van Sony Europe Limited, Da Vincilaan 7-D1, 1935 Zaventem, Belgia

Výrobca: Sony Mobile Communications Inc, 4-12-3 Higashi-Shinagawa, Shinagawa-ku, Tokyo, 140-0002 Japan

Zhoda podľa legislatívy EU: Sony Belgium, bijkantoor van Sony Europe Limited, Da Vincilaan 7-D1, 1935 Zaventem, Belgicko

Proizvajalec: Sony Mobile Communications Inc, 4-12-3 Higashi- Shinagawa, Shinagawa-ku, Tokyo, 140-0002 Japan

Skladnost izdelkov za EU: Sony Belgium, bijkantoor van Sony Europe Limited, Da Vincilaan 7-D1, 1935 Zaventem, Belgija

Fabricante: Sony Mobile Communications Inc, 4-12-3 Higashi- Shinagawa, Shinagawa-ku, Tokyo, 140-0002 Japan

Para la conformidad del producto en la UE: Sony Belgium, bijkantoor van Sony Europe Limited, Da Vincilaan 7-D1, 1935 Zaventem, Bélgica

Tillverkare: Sony Mobile Communications Inc, 4-12-3 Higashi- Shinagawa, Shinagawa-ku, Tokyo, 140-0002 Japan

För EU:s produktöverensstämmelse: Sony Belgium, bijkantoor van Sony Europe Limited, Da Vincilaan 7-D1, 1935 Zaventem, Belgien

Fabricant: Sony Mobile Communications Inc, 4-12-3 Higashi- Shinagawa, Shinagawa-ku, Tokyo, 140-0002 Japan

Pour toute question relative à la conformité des produits dans l'UE: Sony Belgium, bijkantoor van Sony Europe Limited, Da Vincilaan 7-D1, 1935 Zaventem, Belgique

Produttore: Sony Mobile Communications Inc, 4-12-3 Higashi- Shinagawa, Shinagawa-ku, Tokyo, 140-0002 Japan

Per la conformità del prodotto in ambito UE: Sony Belgium, bijkantoor van Sony Europe Limited, Da Vincilaan 7-D1, 1935 Zaventem, Belgio

## FCC Statement

This device complies with Part 15 of the FCC rules. Operation is subject to the following two conditions: (1) This device may not cause harmful interference, and (2) This device must accept any interference received, including interference that may cause undesired operation.



Any change or modification not expressly approved by Sony may void the user's authority to operate the equipment.

This equipment has been tested and found to comply with the limits for a Class B digital device, pursuant to Part 15 of the FCC Rules. These limits are designed to provide reasonable protection against harmful interference in a residential installation. This equipment generates, uses and can radiate radio frequency energy and, if not installed and used in accordance with the instructions, may cause harmful interference to radio communications. However, there is no guarantee that interference will not occur in a particular installation. If this equipment does cause harmful interference to radio or television reception, which can be determined by turning the equipment off and on, the user is encouraged to try to correct the interference by one or more of the following measures:

- Reorient or relocate the receiving antenna.
- Increase the separation between the equipment and receiver.
- Connect the equipment into an outlet on a circuit different from that to which the receiver is connected.
- Consult the dealer or an experienced radio/TV technician for help.

## AVISO IMPORTANTE PARA MÉXICO

La operación de este equipo está sujeta a las siguientes dos condiciones: (1) es posible que este equipo o dispositivo no cause interferencia perjudicial y (2) este equipo o dispositivo debe aceptar cualquier interferencia, incluyendo la que pueda causar su operación no deseada.

Para consultar la información relacionada al número del certificado, refiérase a la etiqueta del empaque y/o del producto.

## Industry Canada Statement

This device complies with RSS-210 of Industry Canada.

Operation is subject to the following two conditions: (1) this device may not cause interference, and (2) this device must accept any interference, including interference that may cause undesired operation of the device.

## Avis d'industrie Canada

Le présent appareil est conforme aux CNR d'Industrie Canada applicables aux appareils radio exempts de licence.

L'exploitation est autorisée aux deux conditions suivantes: (1) l'appareil ne doit pas produire de brouillage, et, (2) l'utilisateur de l'appareil doit accepter tout brouillage radioélectrique subi, même si le brouillage est susceptible d'en compromettre le fonctionnement.